

Cappucci e connettori di protezione

Protection cap and connectors

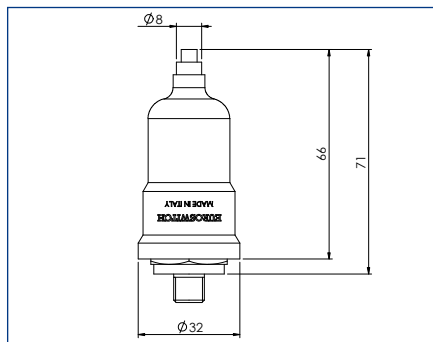

Cappuccio di protezione in gomma

Rubber protective cup

IP54 IP65

cod. 3015001 (Ch. 24 mm)

Per/for MOD. 30-30V-31-31V-35-35V-37-37V-40-40V -41-41V
41BC-42-506-700-42V-80

IP54 IP65

cod. 3015010 (Ch. 27 mm)

Per/for MOD. 27N-28N-357-377

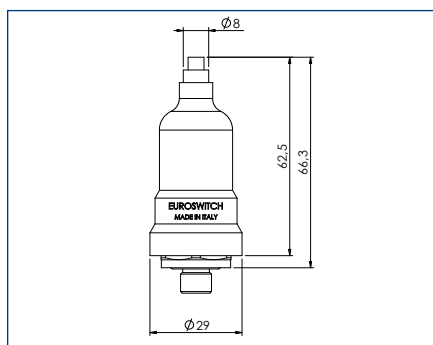

Cappuccio di protezione in gomma

Rubber protective cup

IP54

cod. 3015200 (Ch. 22 mm)

Per/for MOD. 25R-25D-26

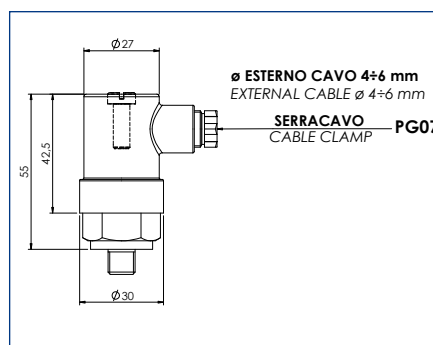

Cappuccio di protezione in plastica

Plastic protective cup

IP65

cod. 3900001

Per/for MOD. 30-30V-31-31V-35-35V-37-37V-40-40V
41-41V-41BC-42-42V-80-506-700

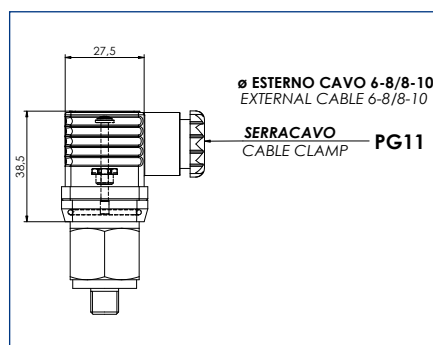

Connettore di protezione

Protective connector

IP65

cod. 3900200

DIN EN 175301-803-A (DIN 43650)

Per/for MOD. 30-31-32-35-37-40-41
41BC-42-80-506-700

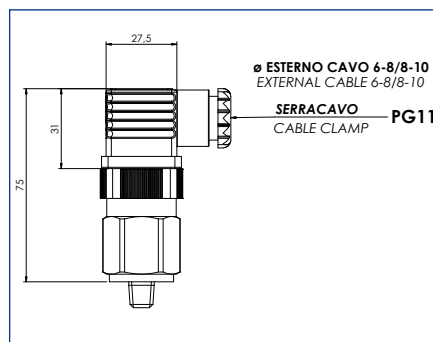

Connettore di protezione con LED luminoso (Rosso/Verde)

Protective connector with LED indicator (Red/Green)

IP65

cod. CNN084-002

DIN EN 175301-803-A (DIN 43650)

Per/for MOD. 38-46-48-49-81
387-691-692-507

Connettori integrati

Integrated connectors

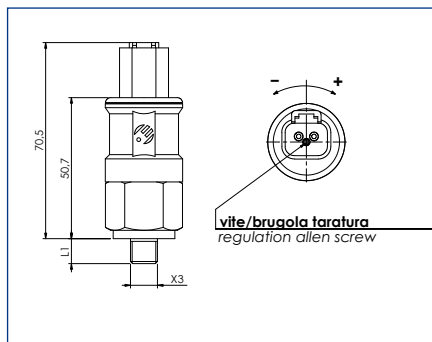

Connettore Deutsch DT04-2P
Connector Deutsch DT04-2P

IP67 / IP69K

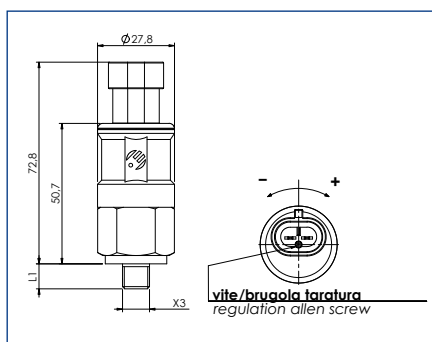

Connettore AMP Superseal 1.5 2 vie
Connector AMP Superseal 1.5 2 way

IP67 / IP69K

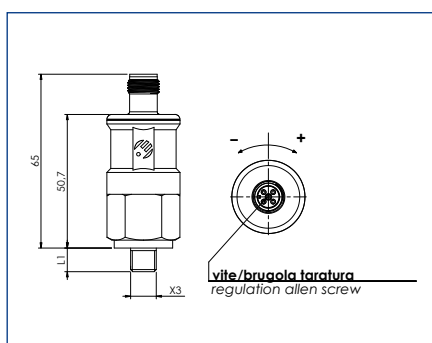

Connettore tipo M12 x 1
Connector type M12 x 1

IP67

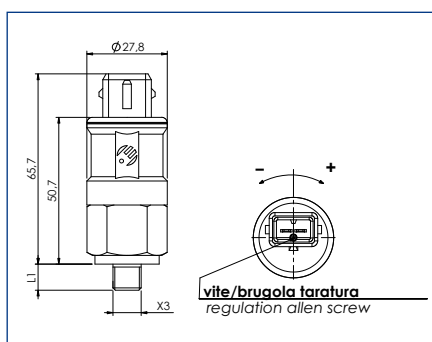

Connettore tipo AMP
Junior power timer
Connector type AMP
Junior power timer

IP65

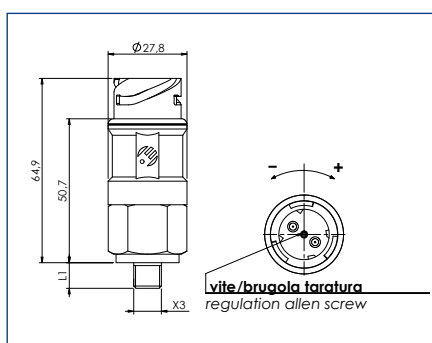

Connettore a baionetta DIN72585
Bayonet connector DIN72585

IP67 / IP69K